



Manual de usuario samsung galaxy pocket gt-s5300

Document has moved here →

Safety precautions

To prevent injury to yourself or others or damage to your phone, read all of the following information before using your device.

Warning: Prevent electric shock, fire, and explosion

- Do not use damaged power cords or plugs, or loose electrical sockets.
- Do not touch the power cord with wet hands, or disconnect the charger by pulling on the cord.
- Do not bend or damage the power cord.
- Do not use your device while charging or touch your device with wet hands.
- Do not attempt to charge the battery.
- Do not plug or cause an impact to the charger or the battery.
- Do not charge the battery with chargers that are not approved by the manufacturer.

- Do not use your device during a thunderstorm. Your device may malfunction and your risk of electric shock is increased.
- Do not handle a damaged or leaking Li-Ion battery. For full information of your Li-Ion battery, contact your nearest authorized service center.

Heads and shape of batteries and chargers with care

- Use only Samsung-approved batteries and chargers specifically designed for your device. Incompatible batteries and chargers can cause malfunctions or damage to your device.
- Never disassemble batteries or devices in use. Follow all local regulations when disposing of used batteries or devices.

Do not store your device with metal objects as coins, keys and needles

- Your device may become deformed or malfunction.
- When battery terminals are in contact with metal objects, it may cause a fire.

Do not store your device near magnetic fields

- Your device may malfunction if the battery may discharge from magnetic fields.
- Magnetic strips, including credit cards, photo cards, passports, and boarding passes, may be damaged by magnetic fields.
- Do not use carrying cases or accessories with magnetic closures or allow your device to come in contact with magnetic fields for extended periods of time.

Do not store your device near or in heaters, radiators, hot cooking equipment, or high pressure containers

- The battery may leak.
- Your device may overheat and cause a fire.

Do not step on your device or cause impacts to your device

- The screen of your device may be damaged.
- If bent or deformed, your device may be damaged or parts may malfunction.

If your device has a camera flash or light, do not use it from close to the eyes of people or pets

- Using a flash close to the eyes may cause temporary loss of vision or damage to the eyes.

Use cautions when exposed to flashing lights

- While using your device, leave some lights on in the room and do not rest the screen too close to your eyes.
- Sensitiveness or dizziness can occur when you are exposed to flashing lights while watching videos or playing Flash-based games for extended periods. If you feel any discomfort, stop using the device immediately.

- Never place batteries or devices on or in heating devices, such as microwave ovens, stoves, or radiators. Batteries may explode when overheated.
- Never crush or puncture the battery. Avoid exposing the battery to high external pressure, which can result in internal short-circuit and overheating.

Protect the device, batteries, and chargers from damage

- Avoid exposing your device and battery to very cold or very hot temperatures.
- Extreme temperatures can cause the deformation of the device and reduce the charging capacity and life of your device and battery.
- Prevent batteries from contacting metal objects, as this can create a short-circuit between the + and - terminals of your battery and lead to temporary or permanent battery damage.
- Never use a damaged charger or battery.

Caution: Follow all safety warnings and regulations when using your device in restricted areas

Turn off your device when prohibited. Comply with all regulations that restrict the use of a mobile device in a particular area.

Do not use your device near other electronic devices

- Most electronic devices use radio frequency signals. Your device may interfere with other electronic devices.
- Do not use your device near a pacemaker.

Do not use your device near a pacemaker

- Avoid using your device within a 15 cm range of a pacemaker if possible, so your device can interfere with the pacemaker.
- If you must use your device, keep at least 15 cm away from the pacemaker.

Reduce the risk of repetitive motion injuries

- When you repeatedly perform actions, such as pressing keys, drawing characters on a touch screen with your finger, or playing games, you may experience occasional discomfort in your face, neck, shoulder, or other parts of your body. When using your device for extended periods, treat the device with a moderate grip, press the keys lightly, and take frequent breaks. If you continue to have discomfort during or after such use, stop use and see a physician.

Ensure maximum battery and charger life

- Avoid charging batteries for more than a week, or recharging any unused battery life.
- Over-time, unused batteries will discharge and must be recharged before use.
- Disconnected chargers from power sources when not in use.
- Use the battery only for their intended purposes.

Use manufacturer-approved batteries, chargers, accessories and supplies

- Using generic batteries or chargers may shorten the life of your device or cause the device to malfunction.
- Screening cannot be performed for the user's safety when using accessories or supplies that are not approved by Samsung.

Do not bite or suck on the device or the battery

- Doing so may damage the device or cause injuries.
- If children use the device, make sure that they use the device properly.

When speaking on the device

- Hold the device upright, so you speak with a traditional phone.
- Speak directly into the microphone.

- To minimize the possible interference with a pacemaker, use your device on the opposite side of your body from the pacemaker.

Do not use your device in a hospital or near medical equipment that can be interfered with by radio frequency

If you frequently use any medical equipment, contact the manufacturer of the equipment to ensure the safety of your equipment from radio frequency.

If you are using a hearing aid, contact the manufacturer for information about radio frequency

Some hearing aids may be interfered with by the radio frequency of your device. Contact the manufacturer to ensure the safety of your hearing aid.

Turn off the device in potentially explosive environments

- Always comply with regulations, instructions and signs in potentially explosive environments.
- Do not use your device at refueling points (service stations), near gas or chemical, and at loading areas.
- Do not store or carry flammable liquids, gases, or explosive materials in the same compartment as the device, its parts, or accessories.

Turn off your device when in an aircraft

Using your device in an aircraft is illegal. Your device may interfere with the electronic navigation instruments of the aircraft.

Electronic devices in a motor vehicle may malfunction due to the radio frequency of your device

Electronic devices in your car may malfunction due to the radio frequency of your device. Contact the manufacturer for more information.

Comply with all safety warnings and regulations regarding mobile device usage while operating a vehicle

While driving, safely operating the vehicle is your first responsibility. Never use your mobile device while driving, if it is possible by law. For your safety and the safety of others, practice good common sense and monitor the following tips:

- Use a hands-free device.
- Get to know your device and its conversation features, such as speed dial and redial. These features help you reduce the time needed to place or receive calls on your mobile device.
- Park your vehicle off or away from traffic. Be able to access your wireless device without removing your eyes from the road. If you receive an incoming call at an inconvenient time, let your voice mail answer it for you.
- Let the person you are speaking with know you are driving. Suspend calls in heavy traffic or hazardous weather conditions. Pull over, slow down, or pull heavy traffic can be hazardous.
- Do not make calls or look at phone numbers. Inform others a "do not" sign is posted on your address book takes attention away from your primary responsibility of driving safely.
- Do not make any calls on the phone. These calls often put you at risk of being pulled into traffic. Try to place calls when your car will be stationary. If you need to make a call, dial only a few numbers, check the road and your mirrors, then continue.
- Do not engage in extended or emotional conversations that may be distracting. Please provide you are talking with anyone you are driving past or engaged in conversations that have the potential to divert your attention from the road.

- Use your device to call for help. Dial a local emergency number in the case of fire, traffic accident, or medical emergency.
- Use your device to help others in an emergency. If you see an auto accident, a crime in progress, or a serious emergency where lives are in danger, call a local emergency number.
- Call roadside assistance at a special, non-emergency assistance number when necessary. If you see a broken-down vehicle posing a safety hazard, a broken traffic signal, a minor traffic accident where no one appears injured, or a vehicle you know to be stolen, call roadside assistance or another special, non-emergency number.

Proper care and use of your mobile device

Keep your device dry

- Handle dry at all times of liquids may damage device parts or electronic circuits.
- Do not turn on your device if it is wet. If your device is already on, turn it off and remove the battery immediately if the device will not turn off or you cannot remove the battery, leave it to dry. Then, use the device with a towel and take it to a service center. Liquids will damage the cover of the label that indicates water damage inside the device. Water damage to your device can void your manufacturer's warranty.

Do not use or store your device in damp, dirty areas

Dust can cause your device to malfunction.

Do not store your device on slopes

If your device falls, it can be damaged.

Do not store your device in hot or cold areas. Use your device at -20 °C to 50 °C

- Your device can expand if it is stored in a cold vehicle, as the inside temperature can reach up to 60 °C.
- Do not expose your device to direct sunlight for extended periods of time (such as on the dashboard of a car).
- Store the battery at 5 °C to 40 °C.

Specific Absorption Rate (SAR) certification information

Your device conforms to European Union (EU) standards that limit human exposure to radio frequency (RF) energy emitted by radio and telecommunications equipment. These standards prevent the sale of mobile phones that exceed a maximum exposure level known as the Specific Absorption Rate, or SAR, of 0.08 W/kg. During testing, the maximum SAR recorded for this model was 0.253 W/kg. In normal use, the actual SAR is likely to be much lower, as the device has been designed to emit only the RF energy necessary to transmit a signal to the nearest base station. By automatically switching back to sleep when possible, your device reduces your overall exposure to RF energy.

The Declaration of Conformity statement at the back of this manual demonstrates your device's compliance with the European Radio & Terminal Telecommunications Equipment (RTE) directive. For more information about the SAR and related EU standards, visit the Samsung website.

Correct disposal of this product

(Applicable in the European Union and other European countries with separate collection systems)

This marking on this product, accessories or device indicates that the product and its electronic accessories (e.g., charger, headset, USB cable) should not be disposed of with other household waste at the end of their working life.

To prevent possible harm to the environment or human health from uncontrolled waste disposal, please separate these items from other types of waste and recycle them responsibly to promote the sustainable reuse of material resources.

Recycling information

Household users should contact either the retailer where they purchased the product, or their local government office, for details of where and how they can take household waste for environmentally safe recycling.

Business users should contact their supplier and check the terms and conditions of the purchase contract. This product and its electronic accessories should not be mixed with other commercial wastes for disposal.

This EUC is compliant with RoHS.

Correct disposal of batteries in this product

(Applicable in the European Union and other European countries with separate battery return systems)

The marking on the battery, manual or packaging indicates that the batteries in this product should not be disposed of with other household waste at the end of their working life. When marked, the chemical symbols Hg, Cd or Pb indicate that the battery contains mercury, cadmium or lead above the reference levels in EC Directive 2006/66. If batteries are not properly disposed of, these substances can cause harm to human health or the environment.

To protect natural resources and to promote material reuse, please separate batteries from other types of waste and recycle them through your local, best battery return system.

Phone layout

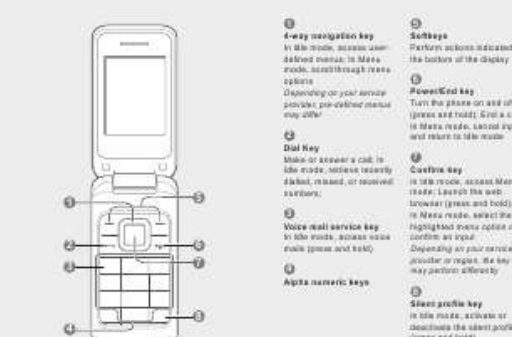

CE 0168

Bienvenido a Samsung ES. Descubre nuestros dispositivos con la tecnología más vanguardista, como televisores, smartphones, tablets, electrodomésticos y.

Aplicación gratuita para desbloquear BCM21553 red basados en dispositivos Galaxy y aplicar reajuste personalizadas contador binario. Raíz necesario!

Ya no puedo desbloquear mi cel samsung galaxy por que intente varias veces en desbloqueo y ya no me acuerdo de mi contrase a de google. Como puede.

La guía completa y definitiva para arreglar tus problemas con Android y los fallos que puedas tener en tu Tableta Android. Respondemos tus dudas y te ayudamos

En Samsung utilizamos cookies propias para mejorar su experiencia de usuario, mejorar nuestros servicios, así como analizar sus hábitos de.

Samsung Service codes for different models of Samsung mobile phones. For all: * 06 Show IMEI * 9999 Show mobile Software Version * 0837 Show mobile.

pues acabo de ver en el soporte y ahora estos son los telefonos samsung soportados Samsung Models: Samsung A837 Samsung A867 Samsung A877 Samsung A887